



# DDC9

## 3-Speed Soft Percussion Diamond Core Drilling Motor

For Wet and Dry Drilling of Reinforced Concrete

June. 2025

Internal & Confidential

**AGP** | DDC9 Rig-Mounted Diamond Core Drilling Motor

### AGP TAIWAN

Lee Yeong Industrial Co., Ltd.

No.2, Kejia Rd., Douliu City, 64057, Taiwan

Tel : 886-5-5518689 Fax : 886-5-5518635

### AGP EUROPE BV

Evenbroekveld 16D, 9420 Erpe-Mere, Belgium

Tel : +32 53 21 62 22 Fax : +32 53 83 88 20



# Introduction & Applications

## DDC9 Introduction

- **Dry Drilling Plus Wet Drilling**

The DDC9 is a versatile core drilling motor for both wet and dry drilling up to 250 mm in reinforced concrete and 350 mm in brick.

- **Constant Speed Motor**

The universal motor is rated at 2500 W input and features constant speed electronics. There are 3 mechanical gear ratios to cover its broad range of operation.

- **Soft Percussion**

Its most special characteristic is its inclusion of switchable soft percussion function and convertible port, which allows vacuum connection for dry drilling, and water feed for wet drilling. This allows the motor to keep its wet drilling capabilities, while adding the capability to dry drill reinforced concrete as well as brick.

- **Safety & Electronics**

Safety and protection of the tool are provided by a robust, yet accurate mechanical clutch in combination with soft-start, thermal protection, overload protection, and anti restart.

The operator is able to monitor the load level visually with the LED Load Indicator, allowing operation at the motor's full potential.

- **Durability**

Durability is ensured by the all metal construction, oil bath gearbox, and the special waterproof Hall-effect switch.

- **Advantages**

This reinforced concrete dry drilling capability will be very useful for situations where water is not allowed or where water would be extremely inconvenient, such as in finished buildings, inverted drilling, and drilling in sub-zero temperatures.

- **Hollow-Core Slabs**

This tool is a perfect solution for dry drilling prestressed hollow-core slabs, where water causes problems.

## Target Groups

The DDC9 will be the primary choice for operators who need to dry drill as well as wet in a large range of diameters in reinforced concrete. It will be a great choice for drilling companies, contractors, and anyone who needs a robust, high performance drilling motor.



# Sales Arguments



## Switchable Soft Percussion

Keeps diamond segments sharp and assists the general efficiency of the drilling process.

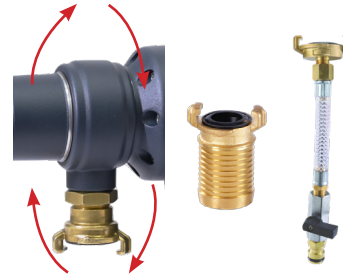

## Integrated Convertible Port

Convertible port allows quick change from water feed for wet drilling, to through-the-spindle dust collection for dry drilling.

The port can be rotated to any desired position.



## Robust Oil-Bath Gearbox

The 3-speed oil-bath gearbox allows optimized torque and drilling speeds for a wide range of diameters. The mechanical slip clutch protects the system.



## Anti-Seize Ring

The motor comes standard with an anti-seize ring which helps prevent the bit becoming stuck on the spindle.



## Constant Speed Motor with Aluminum Housing

The 2500 W motor with constant speed electronics make drilling faster, smoother and more efficient, while extending the life of the core bits. The aluminum housing ensures optimal durability and cooling.



## Special Waterproof Switch

The switch's reed-type operative element is completely impervious to water, dust or slurry, thus eliminating a common failure point in coring motors, and also features anti-restart function.

# Sales Arguments



## Smart Electronic Control system

The Smart Electronic Control system also includes soft-start, thermal protection, and overload protection.



## Spirit Levels

Horizontal and vertical spirit levels are built into the motor for more convenient set-up.



## Highly Visible LED Load Indicator

LED load indicator is large, bright, and in the most visible position, to give the operator reliable guidance on load conditions, making it easy to operate the motor at its optimal load range.

# Technical Specifications

Model	DDC9
Power Input	220 V: 2500 W, 110 V: 2200 W
Voltage, Frequency	110-120 V~ 50-60 Hz or 220-240 V~ 50-60 Hz
No Load Speeds	480 / 1050 / 1500 min <sup>-1</sup>
Rated Load Speeds	320 / 700 / 1450 min <sup>-1</sup>
Percussion Frequency	7 680 / 16 800 / 34 800 bpm
Capacity-Wet or Dry (RC)	Ø250 mm (10")
Capacity Dry (brick)	Ø350 mm (14")
Gear Oil Type	80W-90
Gear Oil Capacity	300 ml
Spindle Thread	1-1/4" UNC male & 1/2" BSP female
Insulation Class	Class I with PRCD / GFCI (110-120V w/o PRCD / GFCI)
Soft Start & Overload Protection	With
Dimensions	647 x 133 x 158 mm (LxWxH)
Weight	8 kg (17.6 lb)

- 1

Spindle
- 2

Anti-Seize Ring
- 3

Percussion Selector
- 4

Motor Unit
- 5

Power Supply Cord
- 6

Horizontal Spirit Level
- 7

Gear Selector
- 8

Vacuum Adaptor Head
- 9

Water Feed Adaptor Head
- 10

Water Feed Valve
- 11

LED Load Indicator
- 12

Vertical Spirit Level
- 13

Motor Start / Stop Switch



## Wet Drilling in Reinforced Concrete

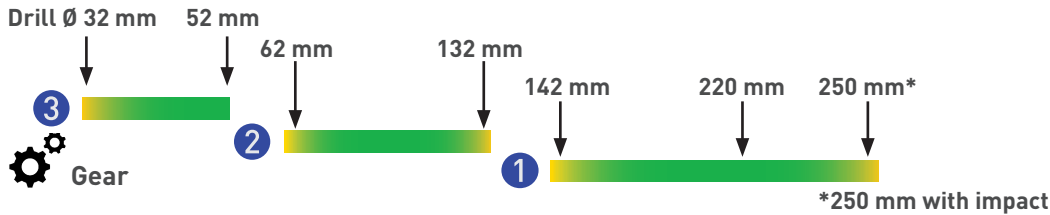

## Dry Drilling in Reinforced Concrete

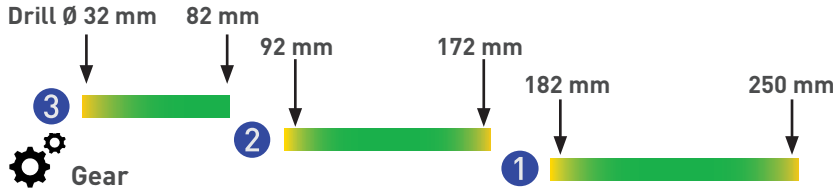



# Offer Content

## Standard Accessories

- ① DDC9 Three-Speed Diamond Core Drilling Motor
- ② Vacuum Adaptor Head
- ③ Water Feed Adaptor Head



## Optional Accessories

### ④ Mounting Plate (S350)

The plate is standard equipment with large AGP drill stands, so you only need to buy the mounting plate if you need to use multiple motors sharing the same drill stand.

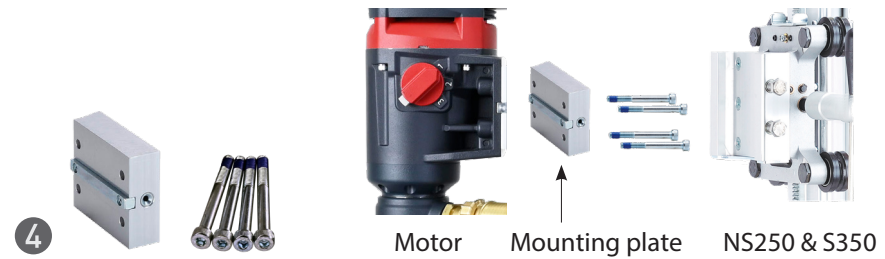

### ⑤ Mounting Plate (AS200)

The DDC9 also has a 2nd bolt hole pattern suitable for installing the AS200 dovetail mounting plate.

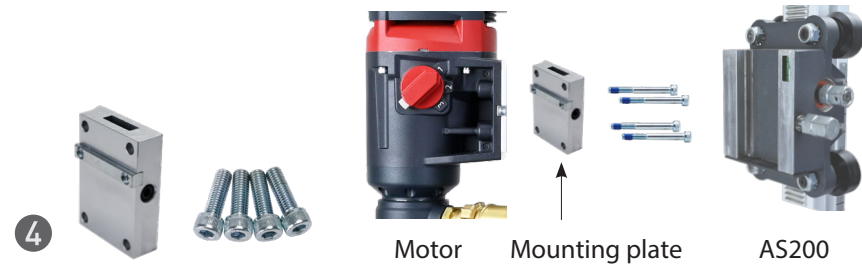

### ⑥ AS200 Drill Stand

### ⑦ S350 Drill Stand



# Comparison Table

Brand



Special Wet & Dry Drilling of Reinforced Concrete with Percussion, Rig Mounted



Model	DDC9	DKS 32 S	DPT 3000 SE-37-4	ESD 200	BDB 8295 (dry only)
Power Input	230 - 240 V: 2500 W	230 V: 3200 W	230 V: 3000 W	230 V: 2500 W	230 V: 2200 W
Rated Load Speed	Gear 1: 320 /min Gear 2: 700 /min Gear 3: 1450 /min	Gear 1: 300 /min Gear 2: 590 /min Gear 3: 930 /min	Gear 1: 420 /min Gear 2: 780 /min Gear 3: 1150 /min	Gear 1: 500 /min Gear 2: 1050 /min	Gear 1: 480 /min Gear 2: 940 /min
Percussion Freq. (rated load)	Gear 1: 6 400 bpm Gear 2: 14 000 bpm Gear 3: 29 000 bpm	Gear 1: 7 200 bpm Gear 2: 14 160 bpm Gear 3: 22 320 bpm	Gear 1: 10 080 bpm Gear 2: 18 720 bpm Gear 3: 28 000 bpm	Gear 1: 10 000 bpm Gear 2: 21 000 bpm	Gear 1: 9 600 bpm Gear 2: 18 800 bpm
Percussion Ratio	20:1	24:1	24:1	20:1	20:1
Capacity-Dry, Reinforced Concrete	250 mm	250 mm	300 mm	250 mm (202 mm optimal)	250 mm
Capacity-Wet, RC	250 mm	250 mm	300 mm	250 mm	N/A
Capacity-Dry, Brick	350 mm	250 mm	300 mm	250 mm (202 mm optimal)	250 mm
Spindle	1-1/4" UNC & 1/2" BSP	1-1/4" UNC	1-1/4" UNC	1-1/4" UNC	1-1/4" UNC
Integrated Dust Collection	Yes	Yes	Yes	No (external)	No (external)

# Comparison Table

Brand

**AGP®**

**WEKA**  
ELEKTROWERKZEUGE





**CARDI**

**EIBENSTOCK**  
Elektrowerkzeuge

**BAIER**  
Elektro-  
werkzeuge

Special Wet & Dry Drilling  
of Reinforced Concrete with  
Percussion, Rig Mounted



Gearbox Lubrication	Oil bath	Oil Bath	Oil Bath	Oil Bath	Oil Bath
Locking Gear Lever	Yes 	No	No	Yes	No
Anti-seize ring	Yes 	Yes	Optional	No	Optional
Spirit Levels	Yes 	No	No	Yes	Yes
Led indicator	Yes 	No	No	Yes	Yes
Switch Type	Dustproof / Waterproof Hall Effect 	Standard Type	Standard Type	Standard Type	Standard Type
Insulation Class	Class 1	Class 1	Class 2	Class 1	Class 2
Motor Housing Material	Aluminum	Aluminum	Aluminum	Plastic	Aluminum
Weight	8 kg	12.4 kg	8.6 kg	8.9 kg	6.21 kg
Street Price (Germany, w/o tax) Internet sourced info		2389,00 €	1850,00 €	910,20 €	1.349,00 €

Conclusion

The AGP **DDC9** is unique with its electronic constant speed design and high output efficiency, giving it outstanding performance. Its broad spread of speeds give it excellent torque with large diameters, and superior performance with small diameters. Its light weight provides ease of handling without sacrificing power. Clearly, the **DDC9** is the most versatile offering in this segment.



# Tool Dimensions (mm)

