



# DME51D Dry Diamond Core Drill Motor

Jan. 2025

Internal & Confidential

**AGP** | DME51D Dry Diamond Core Drill Motor

## AGP TAIWAN

Lee Yeong Industrial Co., Ltd.  
No.2, Kejia Rd., Douliu City, 64057, Taiwan  
Tel : 886-5-5518689 Fax : 886-5-5518635

## AGP EUROPE BV

Evenbroekveld 16D, 9420 Erpe-Mere, Belgium  
Tel : +32 53 21 62 22 Fax : +32 53 83 88 20



# Introduction

## Target group & Applications

### DME51D Introduction

The DME51D is an essential tool for all electricians. It is a powerful single speed dry drilling motor featuring soft percussion and external dust collection for drilling highly abrasive materials. In conjunction with the CG125 wall chaser, it allows the operator to create fast, high quality, socket installations. Compared to traditional methods, it is a quantum improvement.

### Target Group & Applications

This item has a quite specific application, being specially designed for drilling sockets for electricians, usually in the size 82 mm. Thus, it is optimized for this size and has the features needed for this task.



# Sales Arguments



- 1 Dust Extractor Head**  
for use with banana slot type socket bits. External location keeps fine abrasive dust away from the gearbox.



- 2 Switchable Soft Percussion**  
keeps the diamond segments sharp for more efficient dry drilling. Can be turned off when not needed.



- 3 Side Handle**  
is inline with the spindle for best control.

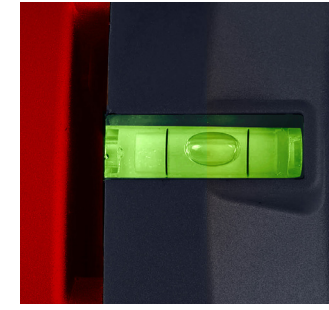

- 4 Tubular Spirit Level**  
ensures accurate drilling angle.

# External Extractor Combinations

AGP external dust extractor comes with a choice of thread forms. Its design makes it easy to mount or remove the core bit, and also to easily free up a blocked bit. The openable access door allows convenient access for your standard-type wrenches. No need to use special wrenches, which may not be available on the job site when you need them!

We are here with solutions!



Watch How to Use  
Dust Extractor Video

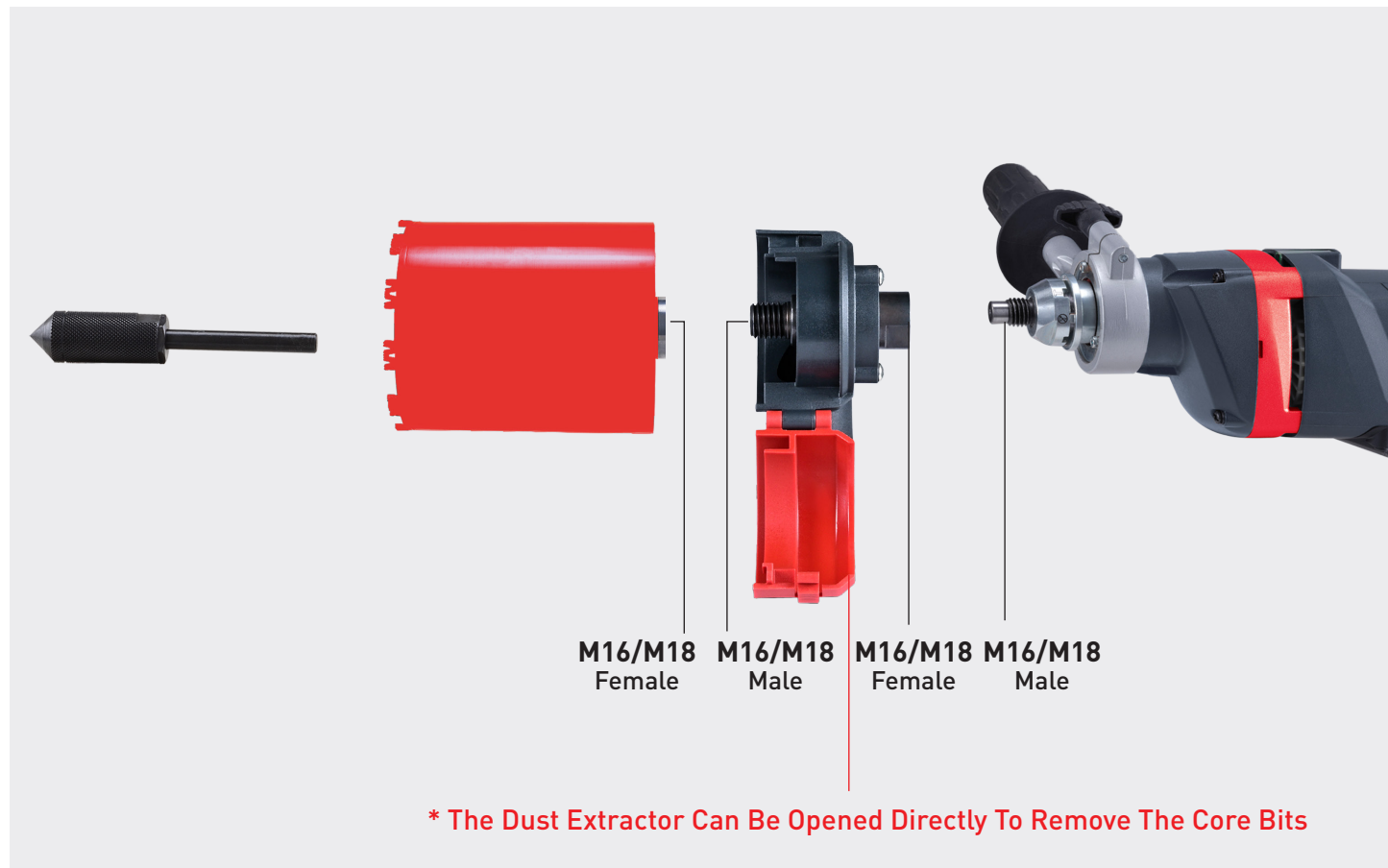

## Dust Extractor

M18-18,  
M18-16  
or  
M16-16

(For use with 68 - 102mm banana-slot core bits)



## Centering Pilot

65mm or  
85mm





# Technical Specification

Model	DME51D
Power Input	1800 W
Voltage	110-120 V~ 50-60 Hz or 220-240 V~ 50-60 Hz
No Load /Full Load Speed	3600 / 2160 min <sup>-1</sup>
Percussion Frequency	56.000 b/min
Arbor Thread	M16-2.0 or M18-2.5
Capacity-Dry	102 mm (4")
Dimensions (mm)	450 x 90 x 210 mm
Neck Diameter	60 mm
Net Weight	4.7 kg



- 1 Side Handle
- 2 Lock Screw (Side Handle)
- 3 Tubular Spirit Level
- 4 Trigger Switch
- 5 Lock Button
- 6 Spindle
- 7 Percussion Selector
- 8 Motor
- 9 Power Supply Cable
- 10 Main Handle
- 11 Hammer Symbol (Percussion On)
- 12 No Hammer Symbol (Percussion Off)

# Offer Content

## Standard Accessories

- ① DME51D Dry Diamond Core Drill Motor
- ② Soft-Grip Side Handle

## Recommended Item

- ③ External Dust Extractor Head
- ④ Centering Pilots for bit lengths 85 mm or 65 mm
- ⑤ Vacuum Collector Pad (Small up to 75 mm, large up to 130 mm)



# Comparison Table

Brand

**AGP®**

**EIBENSTOCK**

**BAIER**  
Elektro-  
werkzeuge





**BAIER**  
Elektro-  
werkzeuge

**EIBENSTOCK**

**WEKA**  
ELEKTROWERKZEUGE

Dry Socket Drilling w/ External  
Dust Collector  
(mostly for Electricians)



Model No.	DME51D	ESD 1801	BDB 822 AP	BDB 824 S	EHD 1500	DK116
Power Input	220-240 V: 1800 W	220-240 V: 1800 W	220-240 V: 1650 W	220-240 V: 2000 W	220-240 V: 1500 W	220-240 V: 1600 W
Capacity-dry	102 mm 	90 mm	40 - 90 mm	40 - 82 mm	82 mm	82 mm
Spindle	M18-2.5 or M16-2.0	M18-2.5 (dust extractor is M16)	M18-2.5 (dust extractor is M16)	M16	M18-2.5 (dust extractor is M16)	M16
RPM (rated load)	2160 /min	0 - 2050 /min	1800 /min	2400 /min	0 - 2000 /min	1500 /min
Percussion Frequency	56 000 bpm 	41 000 bpm	36 000 bpm	N/A	N/A	N/A
Switchable Percussion	YES 	YES	YES	NO	NO	NO
Built-in Level	YES 	NO	YES	YES	NO	YES
Blowcase	YES	YES	YES	YES	YES	YES
Anti-Vibration Side Handle	Optional 	NO	NO	NO	NO	NO
LED Load Indicator	NO	NO	YES	YES	YES	NO
Variable Speed Switch	NO	YES	NO	NO	YES	NO
Weight	4.7 kg	5.9 kg	4.98 kg	5.0 kg	3.9 kg	5.0 kg
Dust Collector Description	Choice of M16 or M18 thread (for banana slot type bits only). No limitation on length.	For M16 thread, short socket bits with banana slot vents only.	For M16 thread, short socket bits with banana slot vents. Also can use side slot socket bits with the optional bell-type dust extractor.	For M16 thread, short socket bits with banana slot vents only.	For M16 thread, short socket bits with banana slot vents only.	For M16 thread, short socket bits with banana slot vents only.
Dust Collector	Optional	Optional	Standard	Standard	Optional	Standard
Centering Aid	Spring-loaded centering pilot	Masonry drill bit	Spring-loaded centering pilot	Built-in spring-loaded centering pilot	Masonry drill bit	Built-in spring-loaded centering pilot integrated with motor
Conclusion	The <b>AGP</b> brings together all the features for the ideal electrician's drill, with the power, percussion, ideal rpm, level, and centering aid to allow optimal drilling. The <b>AGP</b> external dust extractor is uniquely convenient with its access door for easy bit changes.					

# Tool Dimensions (mm)

DME51D

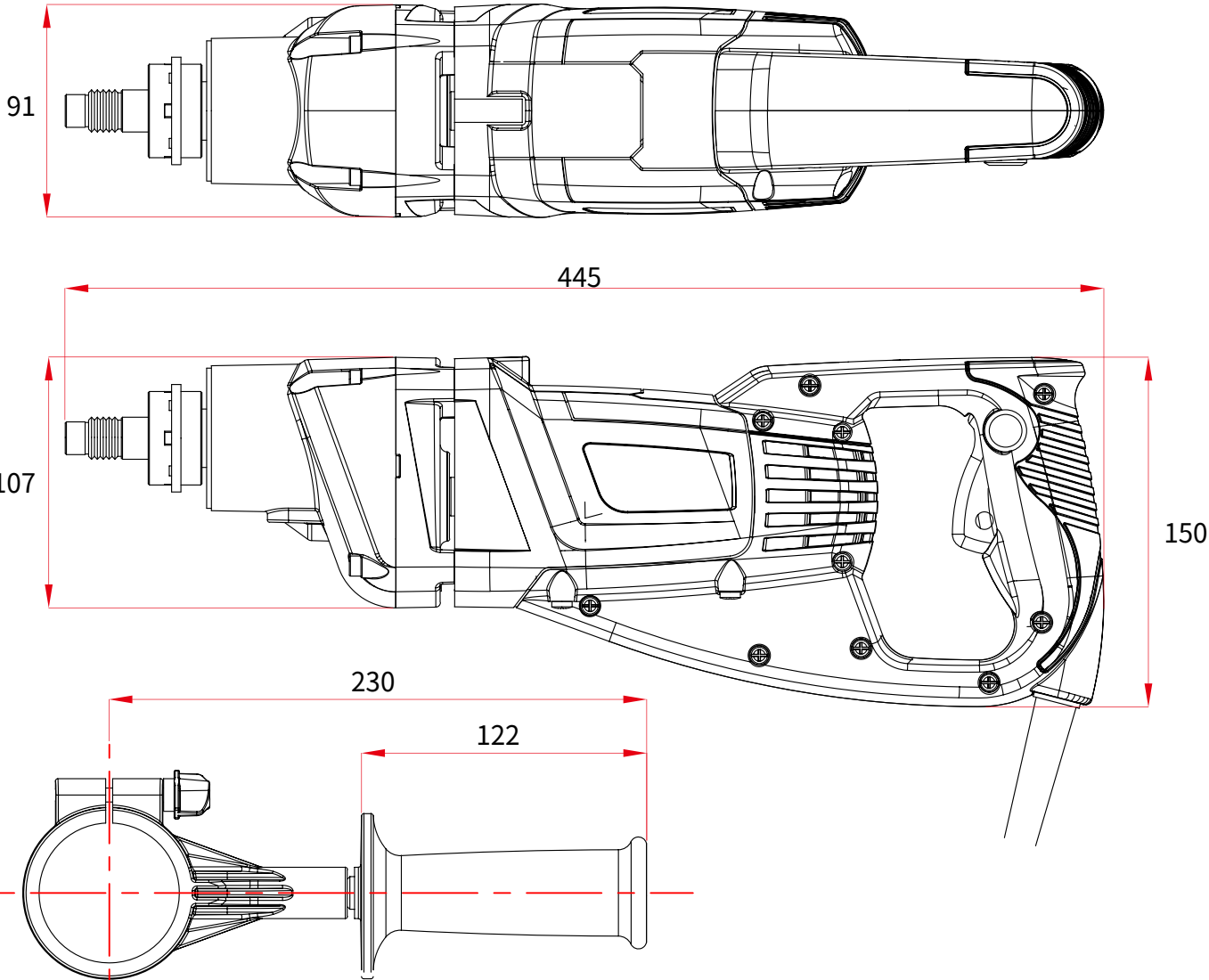

Side Handle

Dust cover

